

A black and white profile of a man's head, facing left. Inside the head, a conference room scene is visible, featuring a long table with several chairs and a pen resting on the table. The man is wearing glasses and a dark suit jacket.

Thinking SPACE

Space to work, Space to create. Space to think.

Rooms flooded with natural daylight and complimentary Wi-fi allow you to get the much needed head space to think.

The Kings Head subtly combines traditional style, great food and excellent service with modern needs, friendly faces and copious space.

KINGSHEAD-HOTEL.CO.UK

01285 700 900

events@kingshead-hotel.co.uk

24 Market Place, Cirencester, GL7 2NR



Kings Head

CIRENCESTER



Flexible meeting space for up to 400 delegates in our stylishly and sympathetically renovated property. A range of event rooms flooded with natural daylight, complimentary Wi-fi and a range of bespoke conferencing solutions to meet your specific requirements for your event.

Location, location, location

Easily accessible from the South West, London and the Midlands, an ideal venue for:

- incentives
- product launches
- team building
- networking
- away day
- training
- drinks reception
- seminars

Delegate packages

Our day packages include:

- hire of a private room for a day or evening
- tea and coffee
- a hot or cold finger buffet lunch
- complimentary broadband internet access
- meeting support from a dedicated conference and events team

We would be pleased to help you with your enquiry. Please contact the events team at the Kings Head by calling: 01285 700 900 or by email on events@kingshead-hotel.co.uk



Smaller Spaces

Only smaller in name these meeting rooms offer everything you could need for up to 40 people, perfect for board meetings, presentations or training sessions.

Watermoor

The Watermoor meeting room is an L-shaped room located on the first floor of the hotel adjoining a Mezzanine area, ideal for break-out sessions. The room is contemporary and enjoys natural daylight along with access to a roof top garden, full air conditioning, adjustable lighting, telephone and Wi-fi access. This room is ideal for high level board meetings, presentations and training.

Room Name	Dimensions	Cocktails	Theatre	Cabaret	Boardroom	Private Dining
Watermoor	9x3.3x2.4m	N/A	20	N/A	12	N/A

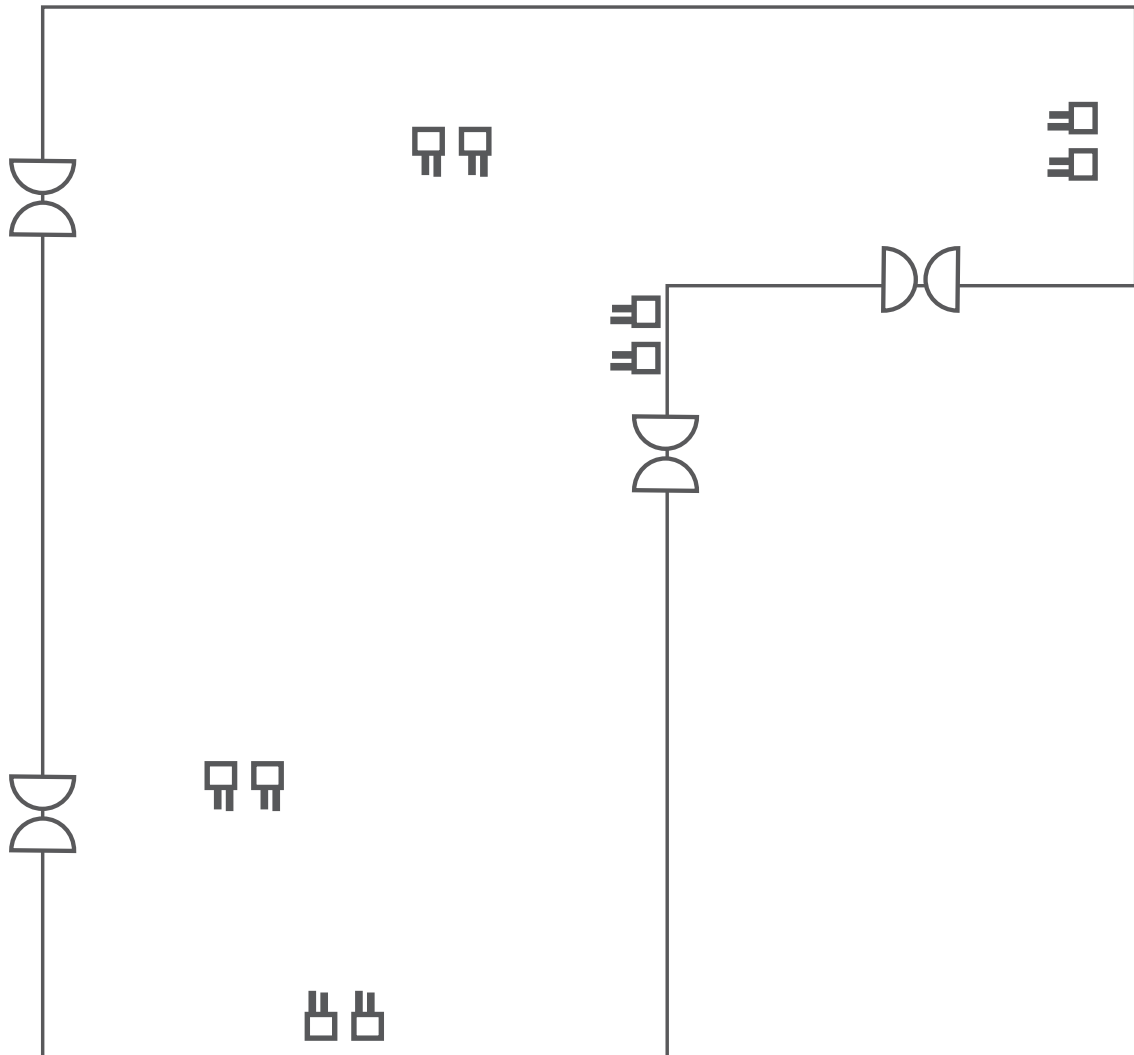

We would be pleased to help you with your enquiry. Please contact the events team at the Kings Head by calling: 01285 700 900 or by email on events@kingshead-hotel.co.uk

Larger Spaces

Our larger spaces are perfect for hosting champagne receptions to exhibitions, large meetings and conferences. But fear not we've not forgotten that its the little details that make the difference.

Chesterton

Located on the first floor of the hotel, the Chesterton offers an attractive space for conference board meetings, training, presentations, small exhibitions and company away days.

The room is fully air conditioned, has adjustable lighting and full Wi-fi access, adjoining a Mezzanine area with access to the roof top garden.

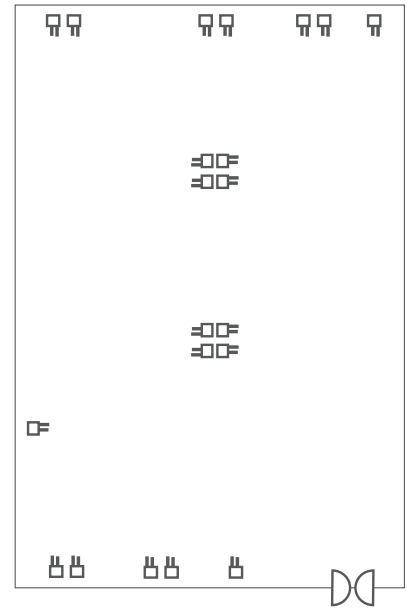

Room Name	Dimensions	Cocktails	Theatre	Cabaret	Boardroom	Private Dining
Chesterton	17.7x5.5x2.7m	200	110	60	24	120

Assembly Room

The Assembly Room will give any event a real sense of occasion, a distinctively impressive space with a host of original architectural features. A versatile event space with it's own private bar, separate mezzanine area and rooftop garden. The room enjoys natural day light, full air conditioning, adjustable lighting and Wi-fi access. Ideal for seminars, presentations, exhibitions, training, meetings and private dining.

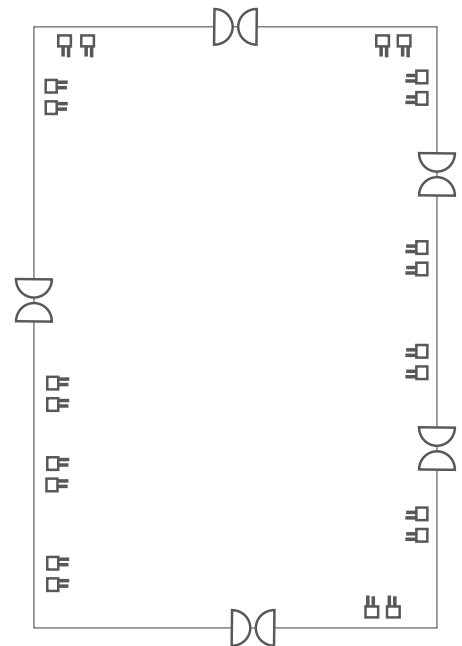

Room Name	Dimensions	Cocktails	Theatre	Cabaret	Boardroom	Private Dining
Assembly Room	21.3x8x5.5m	200	250	84	90	120

We would be pleased to help you with your enquiry. Please contact the events team at the Kings Head by calling: 01285 700 900 or by email on events@kingshead-hotel.co.uk

Larger Spaces

Our larger spaces are perfect for hosting champagne receptions to exhibitions, large meetings and conferences. But fear not we've not forgotten that its the little details that make the difference.

Vaulted Cellar

With its arched walls, ceilings and exposed brickwork, this architectural structure is an event space with a difference. Leather tub chairs, atmospheric lighting and a distinctive Jazz club vibe sets the scene perfectly for you to be dancing the night away with your family, friends and loved ones.

Room name	Dimensions	Cocktails	Theatre	Cabaret	Boardroom	Private Dining
Vaulted Cellar	20x7x2m	200	N/A	N/A	90	120

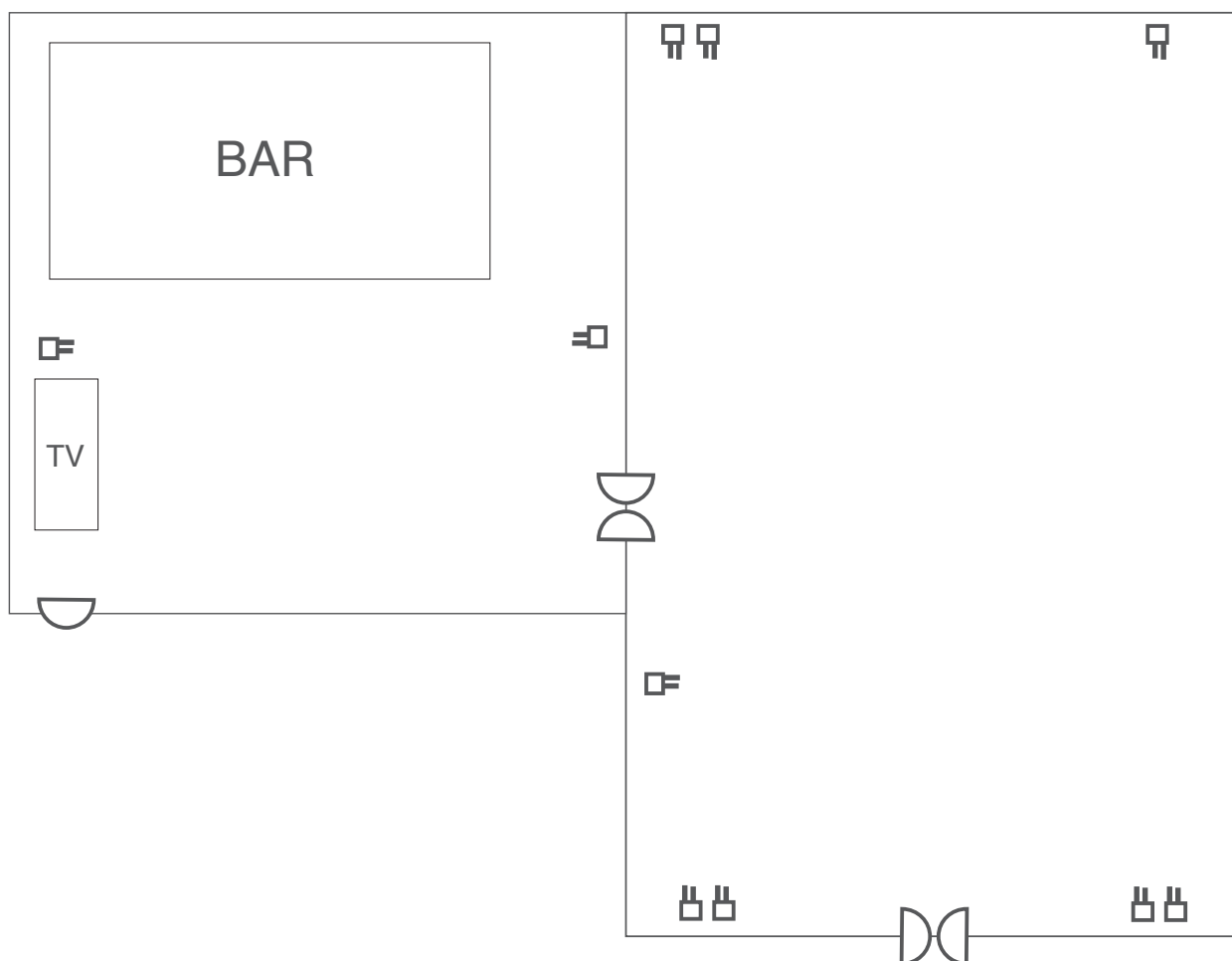

We would be pleased to help you with your enquiry. Please contact the events team at the Kings Head by calling: 01285 700 900 or by email on events@kingshead-hotel.co.uk

Sample Finger Buffet Menu

Tortilla wraps with confit duck

Smoked salmon, dill cream cheese, wasabi peas

Mini shepherd's pie, parmesan mash

Baked fig, goats cheese filo parcel (V)

Sample Hot and cold buffet

Hot

Thai chicken

Green curry, coconut milk, coriander

Seafood paella

Shrimp, mussels, clams

Cold

Ham

Baked on the bone, homemade chutney

Tart

Goats cheese, red onion, chive

Dessert

Mud pie

Triple chocolate

Citrus

Tart, raspberry, clotted cream





Activities

Add something special to your day

Spa experiences

From fitness to beauty and relaxation, we have a wide range of treatments and activities on offer for both individuals and groups. You can even book exclusive use of the spa!

Wine experiences

We can offer an array of wine themed events, seminars and master classes.

Polo

Cirencester Park Polo Club, the most historic Polo club in the UK for the quintessential English Polo experience.

Shooting and fishing

The perfect location to enjoy the traditional pursuits of shooting and fishing.

Outdoor experiences

The Cotsworld Water Park is an area of 40 square miles set across the countryside offering a host of activities including waterskiing, cycling, wind surfing, sailing and riding.

Overnight Accommodation

All of our bedrooms will offer you everything a great boutique hotel should, along with a host of period and architectural features giving each room its own personality. You will find assorted furnishings, great beds, over-sized showers and Nespresso machines.

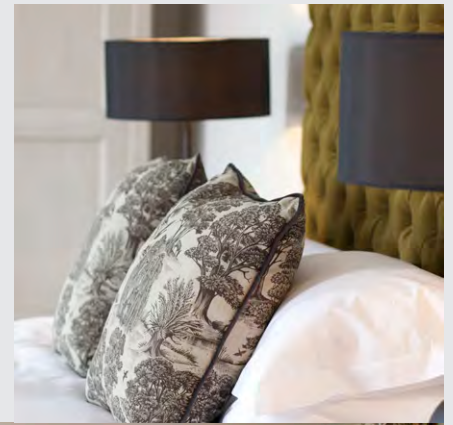

Rooms for your guests

We think the challenge you might have is deciding which rooms and suites you and your colleagues decide to take. Our 24 hour delegate rates are available year round. So for your next meeting enjoy staying in one of the most unique venues in Cirencester and wake you feeling refreshed and invigorated ready for the day ahead.

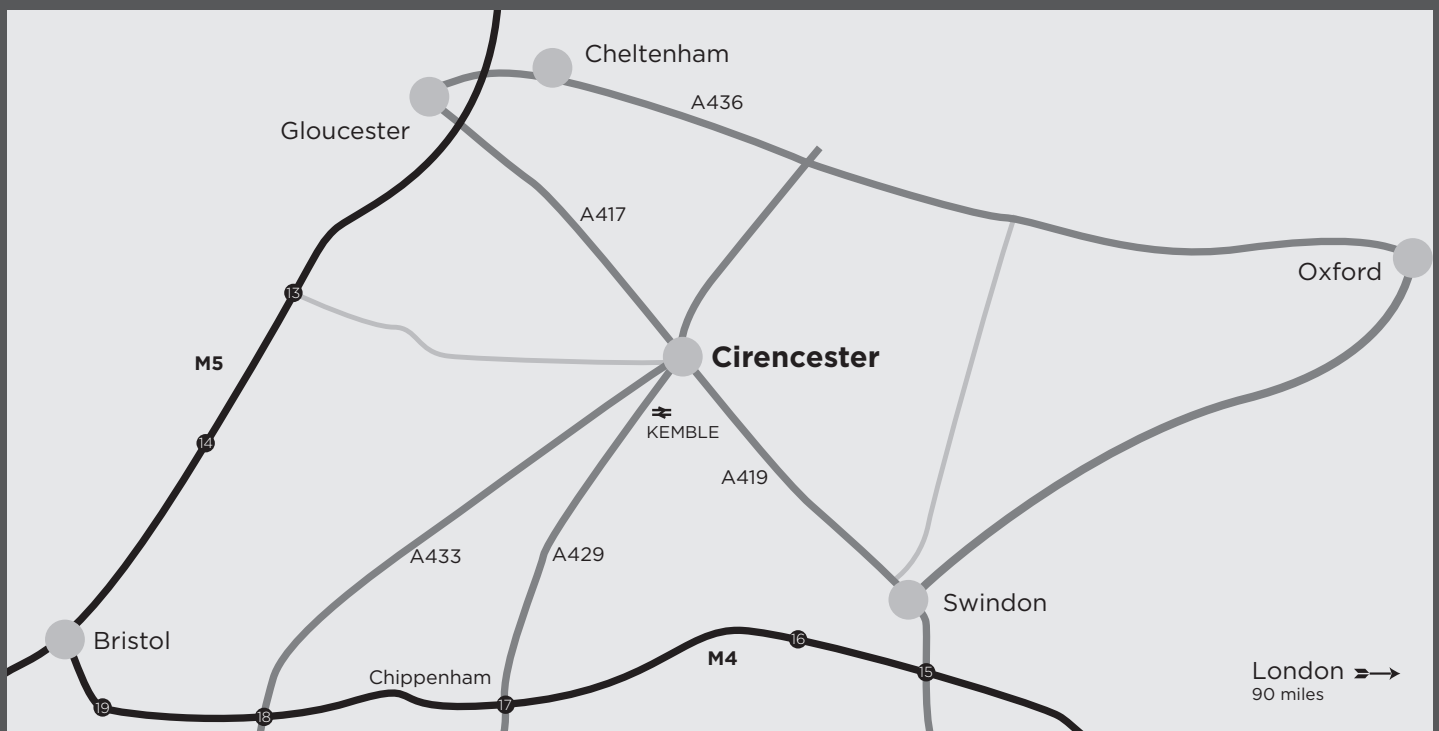

Find your head space

Find Us:

Located just 25 minutes from J15 of the M4 or 40 minutes from J11A of the M5.

The nearest train station with direct links from London Paddington is Kemble which is a mere 4 miles away.

The closest airport Bristol International just 45 miles from the Kings Head.



Kings Head

CIRENCESTER

24 Market Place, Cirencester, GL7 2NR

T +44 (0)1285 700 900
E info@kingshead-hotel.co.uk
W kingshead-hotel.co.uk